

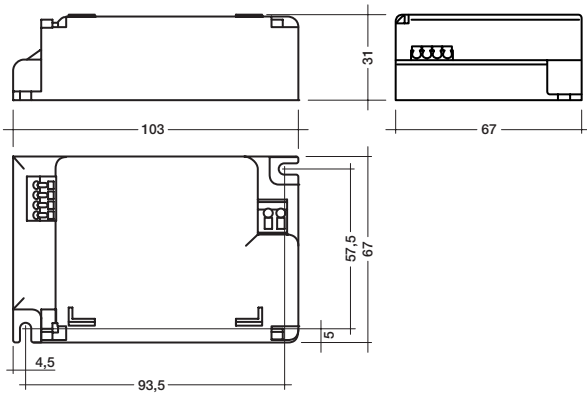

TE 0105 one4all cc 105 VA 230–240/12V 50/60 Hz



- dimming range 1–100 %
- disturbance free, precise control with one4all interface: DALI, DSI, switchDIM
- error feed back and programmable features in both DALI and DSI mode
- lamp wattage 20–105 VA
- short-circuit switch-off with automatic restart

- protection against overheating and overload through regulation of output power with automatic reset
- protection class 2
- compact housing
- DC operation possible, for use in emergency installations according to VDE 0108

Packaging:
box of 15
33 boxes/pallet
495 pieces/pallet

designed according to:
EN 55015
EN 61000-3-2
EN 61047
EN 61347-2-2
EN 61547

type		TE 0105 one4all cc 230–240/12V 105 VA
article number		86456435
primary voltage	V AC	230–240
primary voltage	V DC	230–240
input current at 230V/50 Hz ①	A	0.40
frequency	Hz	0/50/60
secondary voltage ①	V	11.8
lamp wattage	VA	20–105
power reduction at DC	%	70
efficiency	%	> 95
power factor	λ	> 0.95
frequency of output	kHz	33
ambient temperature ta	°C	-25 to +60
rated max. temperature tc	°C	90
softstart		yes
dimming		DALI/DSI/switchDIM
dimensions L x W x H	mm	103 x 67 x 31
fixing centres D	mm	91.5–95.5
weight	kg	0.15
secondary terminal		2 pole

① valid at 100 % dimming level

Dimming:

Dimming range 1% to 100%

Digital control with:

- DSI signal: 8 bit Manchester Code
Maximum speed 1% to 100% in 1.4 s
 - DALI signal: 16 bit Manchester Code
Maximum speed 1% to 100% in <0.7 s
- Programmable parameters:
- Minimum dimming level
 - Maximum dimming level
 - Programmable range
 $1\% \leq \text{MIN} \leq \text{MAX} \leq 100\%$
 - Default minimum = 1%
 - Default maximum = 100%

Dimming curve is adapted to eye sensitivity.

Control input (DA/D1/D2):

Digital DALI/DSI signal or switchDIM can be wired on the same terminals DA/D1/D2.

Digital signal DALI/DSI:

The control input is non-polar and protected against accidental connection with a mains voltage up to 264 V. The control signal is not SELV. Control cable should be installed in accordance to the requirements of low voltage installations. Different functions depending on control modules.

switchDIM:

Integrated switchDIM function allows a direct connection of a push to make switch for dimming and switching. Brief push (50–600 ms) switches transformers ON and OFF. The transformers switch-ON at light level set at switch-OFF. When the push to make switch is held, TE one4all are dimmed. After repush the TE one4all is dimmed in the opposite direction. In installations with TE one4all with different dimming levels or opposite dimming directions (e.g. after a system extension), all TE one4all can be synchronized to 50% dimming level by a 10 s push. The dimming direction will be “down” for the next push.

Light output level in DC operation:

Programmable from 1% to 70%
Programming by extended DSI signal (16 bit) via eDSI.
Default value is 70%
In DC operation dimming is not possible.

Error feedback:

- DSI signal:
lamp failure (open circuit, short-circuit)
- DALI signal:
lamp failure (open circuit, short-circuit)
thermal switch off

Installation instructions

Wiring type and cross section

The wiring can be in flexible cable with ferrules or solid with a cross section of 0.5 to 1.5 mm².

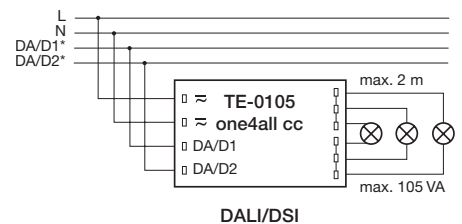
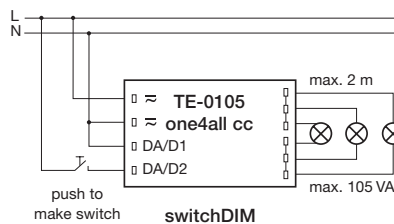
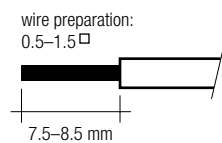

* digital signal DALI or DSI

Loading of automatic circuit breakers (B, C, K):

Automatic circuit breaker type	10A	13A	16A
Installation Ø	1.5 mm ²	1.5 mm ²	1.5 mm ²
TE-0105 one4all cc	20	26	32